

**27TH FLOOR PLAN
UPPER DUPLEX**

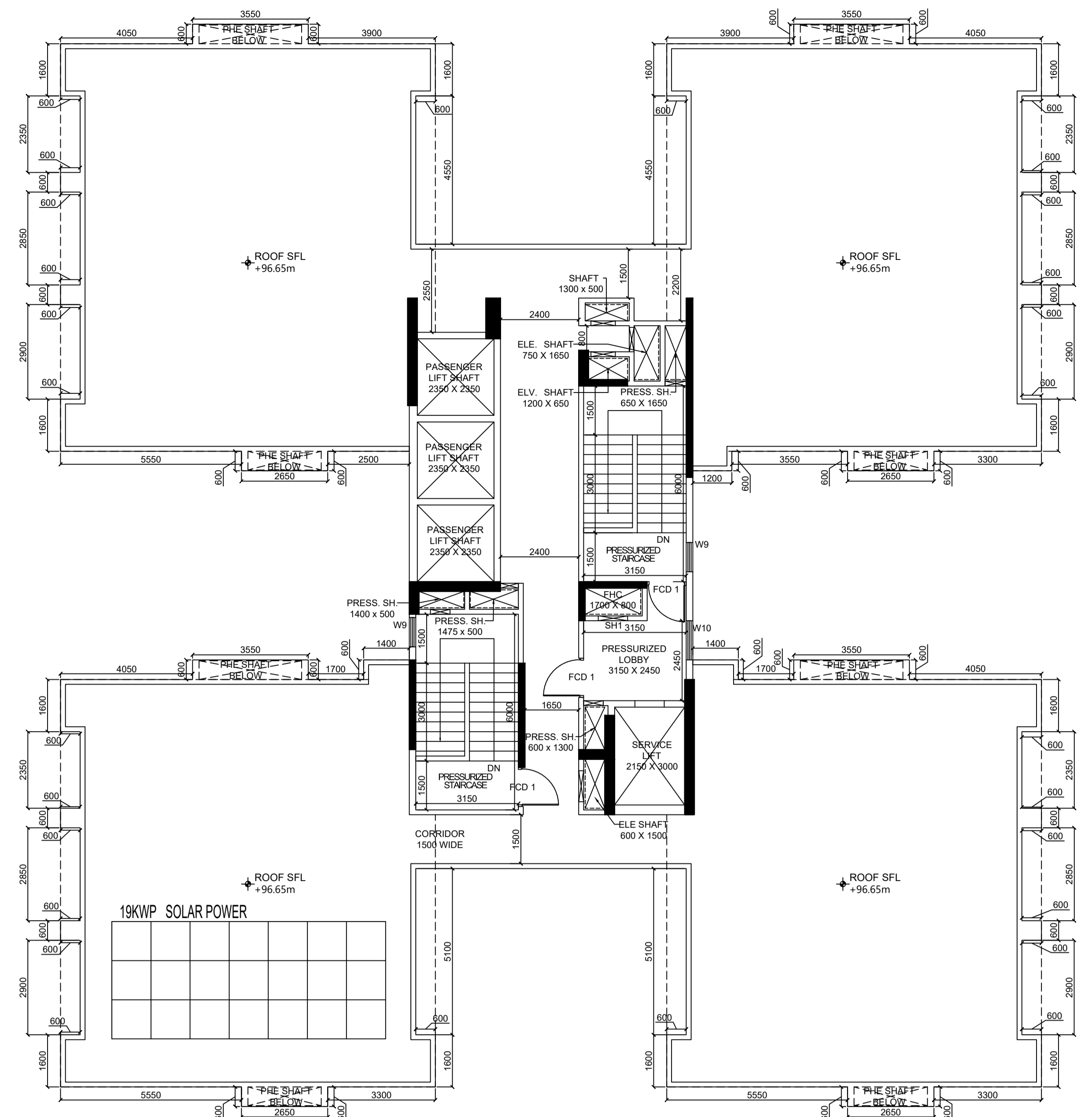

ROOF PLAN

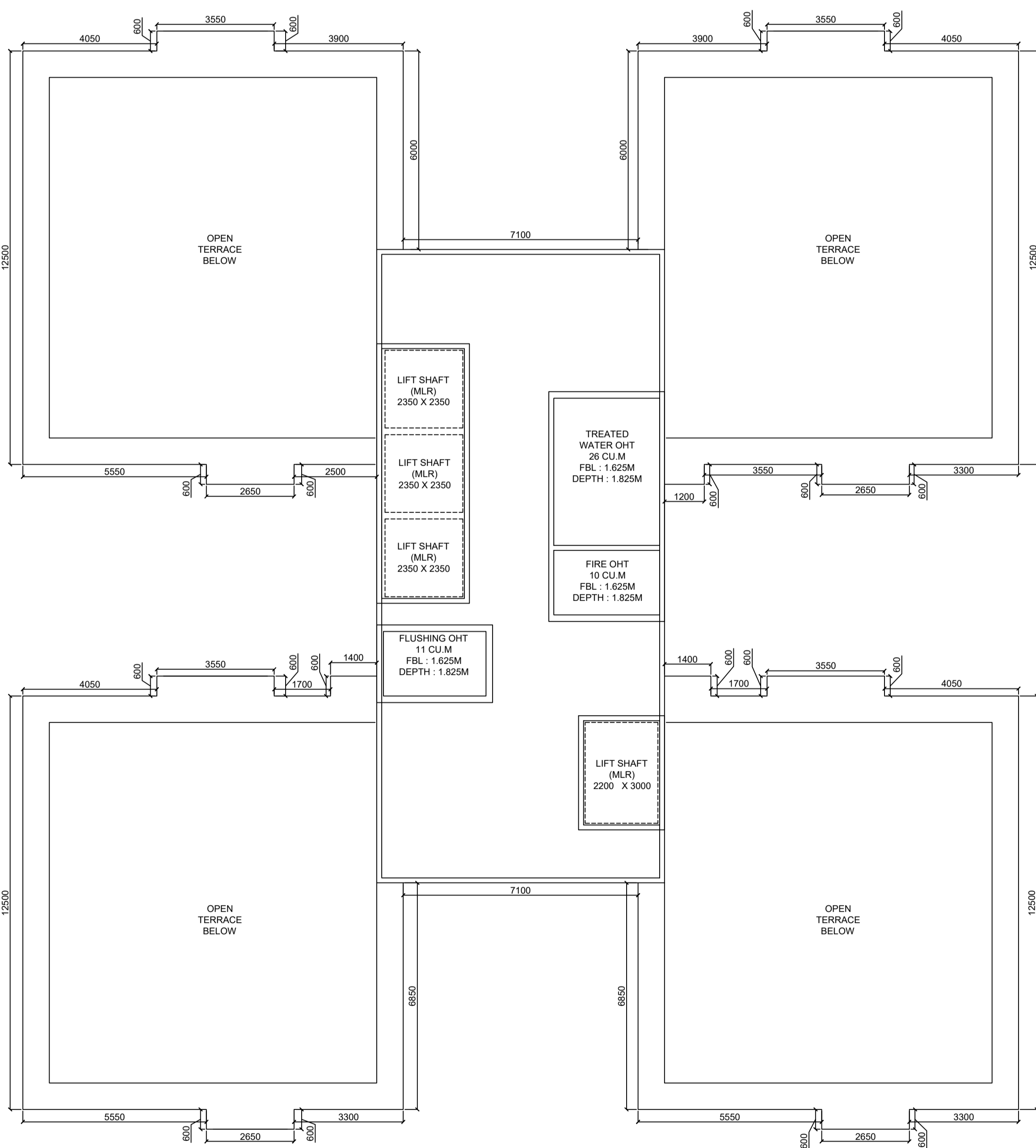

ABOVE ROOF PLAN

DOOR WINDOW SCHEDULE	SIZE
TAG	SIZE
FC01	1200 X 2250
FC02	2000 X 2250
FC03	2400 X 2250
FC04	3000 X 2250
MD1	1200 X 2400
D1	1000 X 2250
D2	1000 X 2250
D3	900 X 2250
D4	800 X 2250
D5	2000 X 2250
D6	1200 X 2250
DD1	1800 X 2400
DD2	1500 X 2400
DD3	2000 X 2400
DD4	2700 X 2400
DD5	3000 X 2400
DD6	2550 X 2400
DD7	2850 X 2400
DD8	2850 X 2400
DD9	2850 X 2400
DD10	2850 X 2400
DD11	2850 X 2400
DD12	2850 X 2400
DD13	2850 X 2400
DD14	2850 X 2400
DD15	2850 X 2400
DD16	2850 X 2400
DD17	2850 X 2400
DD18	2850 X 2400
DD19	2850 X 2400
DD20	2850 X 2400
DD21	2850 X 2400
DD22	2850 X 2400
DD23	2850 X 2400
DD24	2850 X 2400
DD25	2850 X 2400
DD26	2850 X 2400
DD27	2850 X 2400
DD28	2850 X 2400
DD29	2850 X 2400
DD30	2850 X 2400
DD31	2850 X 2400
DD32	2850 X 2400
DD33	2850 X 2400
DD34	2850 X 2400
DD35	2850 X 2400
DD36	2850 X 2400
DD37	2850 X 2400
DD38	2850 X 2400
DD39	2850 X 2400
DD40	2850 X 2400
DD41	2850 X 2400
DD42	2850 X 2400
DD43	2850 X 2400
DD44	2850 X 2400
DD45	2850 X 2400
DD46	2850 X 2400
DD47	2850 X 2400
DD48	2850 X 2400
DD49	2850 X 2400
DD50	2850 X 2400
DD51	2850 X 2400
DD52	2850 X 2400
DD53	2850 X 2400
DD54	2850 X 2400
DD55	2850 X 2400
DD56	2850 X 2400
DD57	2850 X 2400
DD58	2850 X 2400
DD59	2850 X 2400
DD60	2850 X 2400
DD61	2850 X 2400
DD62	2850 X 2400
DD63	2850 X 2400
DD64	2850 X 2400
DD65	2850 X 2400
DD66	2850 X 2400
DD67	2850 X 2400
DD68	2850 X 2400
DD69	2850 X 2400
DD70	2850 X 2400
DD71	2850 X 2400
DD72	2850 X 2400
DD73	2850 X 2400
DD74	2850 X 2400
DD75	2850 X 2400
DD76	2850 X 2400
DD77	2850 X 2400
DD78	2850 X 2400
DD79	2850 X 2400
DD80	2850 X 2400
DD81	2850 X 2400
DD82	2850 X 2400
DD83	2850 X 2400
DD84	2850 X 2400
DD85	2850 X 2400
DD86	2850 X 2400
DD87	2850 X 2400
DD88	2850 X 2400
DD89	2850 X 2400
DD90	2850 X 2400
DD91	2850 X 2400
DD92	2850 X 2400
DD93	2850 X 2400
DD94	2850 X 2400
DD95	2850 X 2400
DD96	2850 X 2400
DD97	2850 X 2400
DD98	2850 X 2400
DD99	2850 X 2400
DD100	2850 X 2400
DD101	2850 X 2400
DD102	2850 X 2400
DD103	2850 X 2400
DD104	2850 X 2400
DD105	2850 X 2400
DD106	2850 X 2400
DD107	2850 X 2400
DD108	2850 X 2400
DD109	2850 X 2400
DD110	2850 X 2400
DD111	2850 X 2400
DD112	2850 X 2400
DD113	2850 X 2400
DD114	2850 X 2400
DD115	2850 X 2400
DD116	2850 X 2400
DD117	2850 X 2400
DD118	2850 X 2400
DD119	2850 X 2400
DD120	2850 X 2400
DD121	2850 X 2400
DD122	2850 X 2400
DD123	2850 X 2400
DD124	2850 X 2400
DD125	2850 X 2400
DD126	2850 X 2400
DD127	2850 X 2400
DD128	2850 X 2400
DD129	2850 X 2400
DD130	2850 X 2400
DD131	2850 X 2400
DD132	2850 X 2400
DD133	2850 X 2400
DD134	2850 X 2400
DD135	2850 X 2400
DD136	2850 X 2400
DD137	2850 X 2400
DD138	2850 X 2400
DD139	2850 X 2400
DD140	2850 X 2400
DD141	2850 X 2400
DD142	2850 X 2400
DD143	2850 X 2400
DD144	2850 X 2400
DD145	2850 X 2400
DD146	2850 X 2400
DD147	2850 X 2400
DD148	2850 X 2400
DD149	2850 X 2400
DD150	2850 X 2400
DD151	2850 X 2400
DD152	2850 X 2400
DD153	2850 X 2400
DD154	2850 X 2400
DD155	2850 X 2400
DD156	2850 X 2400
DD157	2850 X 2400
DD158	2850 X 2400
DD159	2850 X 2400
DD160	2850 X 2400
DD161	2850 X 2400
DD162	2850 X 2400
DD163	2850 X 2400
DD164	2850 X 2400
DD165	2850 X 2400
DD166	2850 X 2400
DD167	2850 X 2400
DD168	2850 X 2400
DD169	2850 X 2400
DD170	2850 X 2400
DD171	2850 X 2400
DD172	2850 X 2400
DD173	2850 X 2400
DD174	2850 X 2400
DD175	2850 X 2400
DD176	2850 X 2400
DD177	2850 X 2400
DD178	2850 X 2400
DD179	2850 X 2400
DD180	2850 X 2400
DD181	2850 X 2400
DD182	2850 X 2400
DD183	2850 X 2400
DD184	2850 X 2400
DD185	2850 X 2400
DD186	2850 X 2400
DD187	2850 X 2400
DD188	2850 X 2400
DD189	2850 X 2400
DD190	2850 X 2400
DD191	2850 X 2400
DD192	2850 X 2400
DD193	2850 X 2400
DD194	2850 X 2400
DD195	2850 X 2400
DD196	2850 X 2400
DD197	2850 X 2400
DD198	2850 X 2400
DD199	2850 X 2400
DD200	2850 X 2400

DECLARATION OF GEO TECHNICAL ENGINEER :
UNDERSIGNED HAS INSPECTED THE SITE AND CARRIED OUT SOIL INVESTIGATION THEREON. IT IS CERTIFIED THAT THE EXISTING SOIL OF THE SITE IS ABLE TO CARRY THE LOAD COMING FROM THE PROPOSED CONSTRUCTION AND THE FOUNDATION SYSTEM PROPOSED HEREIN IS SAFE AND STABLE IN ALL RESPECT FROM GEO TECHNICAL POINT OF VIEW.

SIGNATURE OF GEO TECHNICAL ENGINEER
JISHNU PAL
ENROLLMENT NO. : G.T/11/32

DECLARATION OF STRUCTURAL ENGINEER :
THE STRUCTURAL DESIGN & DRAWING OF BOTH FOUNDATION & SUPERSTRUCTURE OF THE BUILDING HAS BEEN MADE BY ME CONSIDERING ALL POSSIBLE LOADS INCLUDING SEISMIC LOAD AS PER THE NATIONAL BUILDING CODE OF INDIA & CERTIFIED THAT IT IS SAFE & STABLE IN ALL RESPECT THE RECOMMENDATIONS OF SOIL TEST REPORT HAS BEEN CONSIDERED DURING STRUCTURAL CALCULATION.

SIGNATURE OF STRUCTURAL ENGINEER
ANKIT AGARWALA
ENROLLMENT NO. : ESE/1172

NOTE:
1. ALL DIMENSIONS ARE IN MM UNLESS OTHERWISE SPECIFIED.
2. GRADE OF CONCRETE WILL BE AS PER STRUCTURAL DESIGN
3. GRADE OF STEEL FE500 I.S. CODE 1786-1979
4. ALL INTERNAL DRIVEWAYS ARE CAPABLE OF CARRYING 45MT LOAD
5. ALL SPACES MARKED WITH ASTERISK* ARE MECHANICALLY VENTILATED

DECLARATION OF STRUCTURAL REVIEWER :
I HAVE REVIEWED/CHECKED THE STRUCTURAL DRAWING AND DESIGN DETAILS OF THIS PROJECT WHICH HAS BEEN PREPARED BY THE STRUCTURAL ENGINEER ANKIT AGARWALA, HAVING E.S.E NO. ESE/11/104 WHICH HAS BEEN DONE COMPLYING RELEVANT I.S. CODE INCLUDING SEISMIC AND NATIONAL BUILDING CODE.
I CERTIFY THAT THE STRUCTURE WILL BE SAFE AND STABLE AGAINST ALL VERTICAL AND LATERAL LOADS AND WILL BE FIT FOR HABITABLE USE.

SIGNATURE OF STRUCTURAL REVIEWER
UTPAL SANTRA
E.S.R.NO.(STRUCTURAL REVIEWER)-ESR(I)/58/10

CERTIFICATE OF OWNER
I HEREBY DECLARE WITH FULL RESPONSIBILITY THAT I SHALL ENGAGE WITH THE ARCHITECT & ESE DURING CONSTRUCTION. I SHALL FOLLOW THE INSTRUCTIONS OF THE ARCHITECT & ESE DURING CONSTRUCTION. KMC AUTHORITY IS NOT LIABLE FOR STRUCTURAL STABILITY OF THE BUILDING AND ADJOINING STRUC. KMC AUTHORITY MAY REVOKE SANCTION PLAN IF ANY DOCUMENT IS FOUND FAKE.

Mr. Indranil Sen
(AUTHORIZED SIGNATORY)
AMBUJA REALTY DEVELOPMENT LTD.

CERTIFICATE OF THE ARCHITECT
THIS IS TO CERTIFY THAT THE BUILDING PLAN HAS BEEN DRAWN AS PER THE PROVISIONS OF K.M.C BUILDING RULE 2009 AS AMENDED FROM TIME TO TIME. ABUTTING K.M.C. ROAD CONFORMS WITH THE PLAN & THAT IT IS A BUILDABLE SITE.

SIGNATURE OF THE ARCHITECT
NANDA KUMAR V.
CA/2004/34973

PROJECT DETAILS
PROPOSED PLAN FOR B+G+XXVII STORED RESIDENTIAL BUILDING COMPRISING OF SIX TOWERS ALONG WITH ONE NO. OF CLUB BUILDING (B+G+2) CONNECTED AT BASEMENT, GROUND & PODIUM LEVEL AND A SINGLE STOREY TEMPLE BLOCK AT - PREMISES NO. 826, CHOWBAGHA, RS. PLOT NO. I, DAG NO. 651 (PART) KHATAN NO. 815 IN MOUZA NONADANGA, JL NO 10, BOROUGH NO. XII, WARD NO. 108, P. S. -ANANDAPUR P. O. -ANANDAPUR, KOLKATA 700107. COMPLYING KMC BUILDING RULE 2009 (READ WITH RULE 69A(I)(a), 70(5) & 69(2)(g)) U/S 383A OF KMC ACT, 1980. ASSESSEE NO. : 311080310436

**PROPOSED 27TH FLOOR PLAN
PROPOSED ROOF PLAN
PROPOSED ABOVE ROOF PLAN**
DRAWING NUMBER: UTPALAA/SANC./ C-19
SCALE: 1:100
DATE: 22.10.2024
ISSUE STATUS: SANCTION

SIG. OF A.E.(C)/BLDG./BOR.-XII/K.M.C.
SIG. OF E.E.(C)/BLDG./BOR.-XII/K.M.C.
SPACE FOR K.M.C.
BUILDING PERMIT (B.P) NO :- 2024120400
DATE OF SANCTION :- 15.01.2025
THE SANCTION IS VALID UP TO :- 14.01.2030

